

(Reference Mechanical Design)

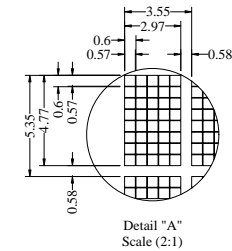

Detail "A"
Scale (2:1)

PIN	SYMBOL	DESCRIPTION
1	N.C.	
2	VSL	
3	VSS	
4	REGVDD	
5	SHLC	
6	SHLS	
7	VDD	
8	VDDIO	
9	BS0	
10	BS1	
11	BS2	
12	GPIO	
13	CS#	
14	RES#	
15	D/C#	
16	R/W#(WR#)	
17	E(RD#)	
18	DO	
19	D1	
20	D2	
21	D3	
22	D4	
23	D5	
24	D6	
25	D7	
26	IREF	
27	ROM0	
28	ROM1	
29	OPRO	
30	OPR1	
31	VCOMH	
32	VCC	
33	N.C.	

NOTES:

- COLOR: GREEN
- DRIVE DUTY: 1/32
- DRIVER IC: US2066
- OPERATING TEMP.: -40°C ~ 85°C
- STORAGE TEMP.: -40°C ~ 90°C
- INTERFACE: 4-/8-BIT 6800/8080 PARALLEL, SPI, I²C
- GENERAL TOLERANCE: ±0.3MM
- THE TOTAL THICKNESS (2.10MAX.) IS WITHOUT POLARIZER PROTECTIVE FILM & REMOVE TAPE. THE ACTUAL ASSEMBLED TOTAL THICKNESS WITH ABOVE MATERIALS SHOULD BE 2.35MAX.
- ROHS COMPLIANT

MULTI-INNO TECHNOLOGY CO., LTD.			
DRAWN BY:	CAROL	2014.08.23	MODULE P/N: MI2004A0-G
CHECKED BY:			
APPROVED BY:			DESCRIPTION: OLED MODULE
VERSION NO:	01		
		SCALE : 1/1	UNIT: mm
		SHEET NO.: 1/1	

01	FIRST ISSUE	CAROL	2014.08.23
VER.	REVISED DESCRIPTION	REVISER	DATE